

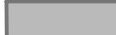

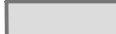

Spremembe in dopolnitve zazidalnega načrta stanovanjske gradnje na Hmelini

Funkcionalno oblikovalski pogoji

LEGENDA:

-  meja območja sprememb in dopolnitev (meja gradbene parcele)
-  tloris pritličja stanovanjske stavbe
-  tloris pomožnega objekta (garaža)
-  obod strehe
-  dostop
-  odmik od meje gradbene parcele 1.6
-  dimenzije gradbene površine 7.6
-  tlakovane površine

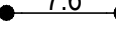
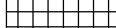
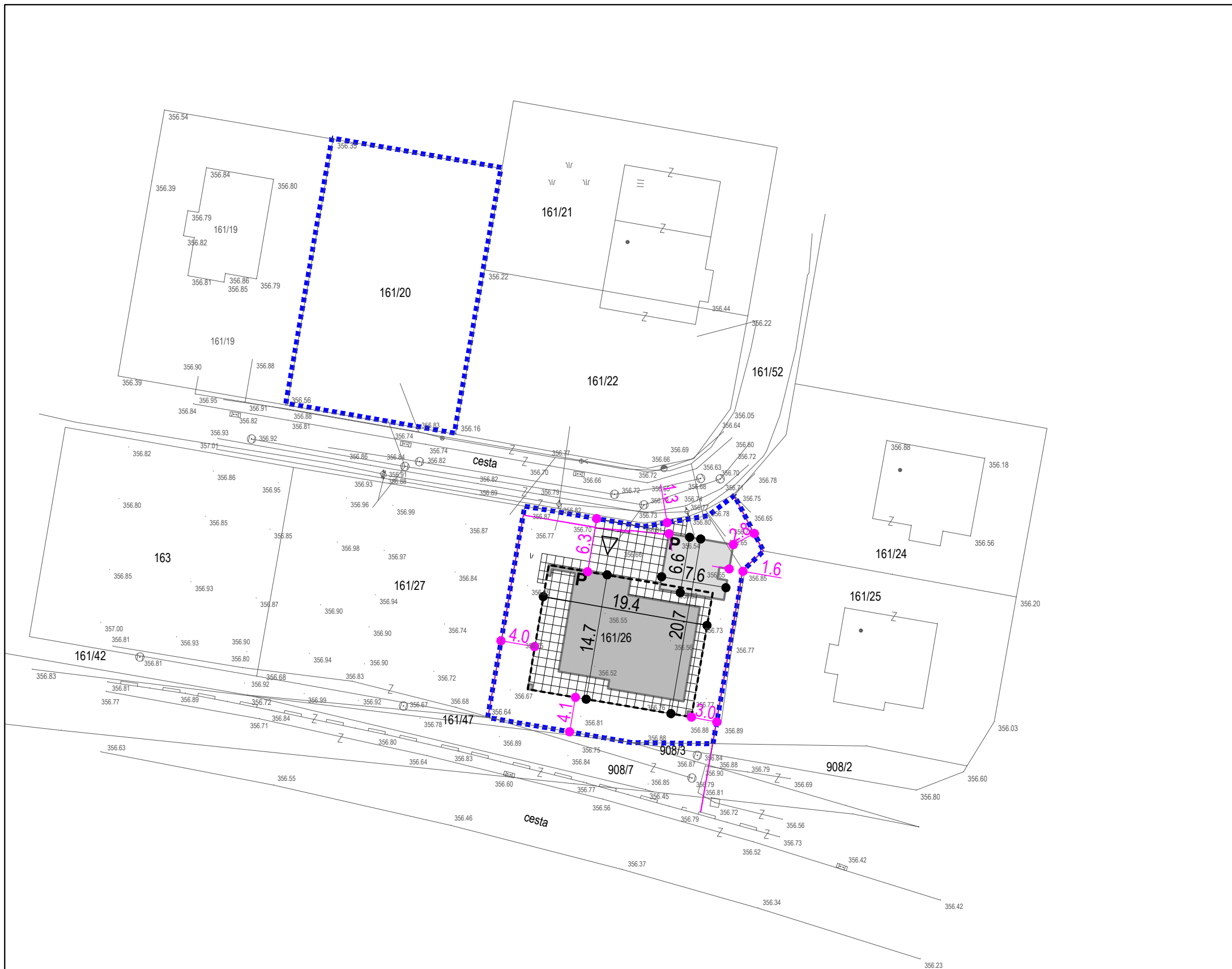

MERILO: 1 : 500

NAROČNIK : MP Marjan Potnik s. p. in Bernhard Pušnik
ŠTEVILKA D.N.: 19035 (19063)

IZDELAL: ZUM URBANIZEM, PLANIRANJE, PROJEKTIRANJE d.o.o.

DATUM IZDELAVE: december 2019